

POWER BRAKE UNIT REMOVAL/INSTALLATION (R.H.D.)

B3E041143800W05

1. Perform the following procedure and move the cooler hose (LO) to the position shown in the figure. (ZJ, Z6)

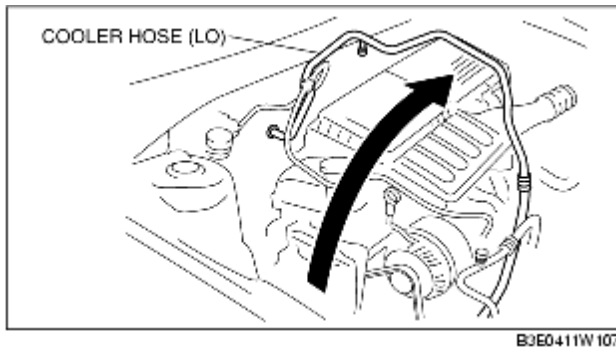

- (1) Remove the suction hose.
- (2) Detach the accelerator cable and move it out of the way.

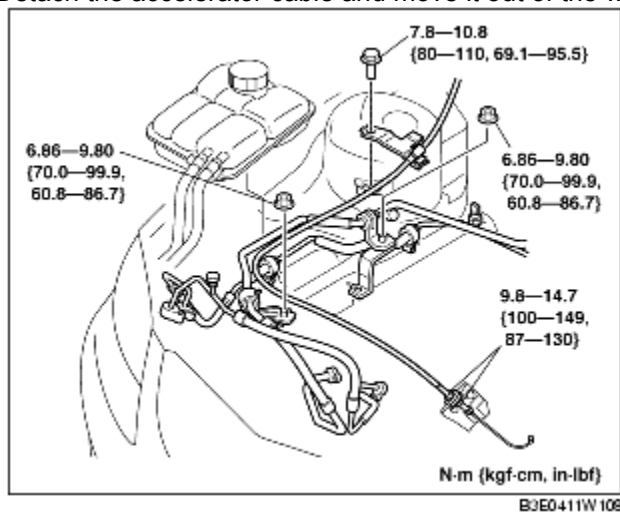

- (3) Remove the coolant reserve tank from the vehicle and move it out of the way.
- (4) Remove the cooler hose (LO) installation nuts.

2. Perform the following procedure and move the cooler hose (LO) under the vehicle. (LF)

- (1) Disconnect the HO2S connector.
- (2) Remove the bracket.
- (3) Remove the cooler hose bracket.

3. Remove the master cylinder. (See [MASTER CYLINDER REMOVAL/INSTALLATION](#).)
4. Remove the brake switch connector.
5. Remove the accelerator pedal. (See [BRAKE PEDAL REMOVAL/INSTALLATION](#).)
6. Remove in the order indicated in the table.
7. Install in the reverse order of removal.
8. After installation, inspect the brake pedal. (See [BRAKE PEDAL INSPECTION](#).)
9. Adjust the accelerator cable. (See [ACCELERATOR CABLE INSPECTION/ADJUSTMENT \[ZJ, Z6\]](#).) (See [ACCELERATOR CABLE INSPECTION/ADJUSTMENT \[LF\]](#).)

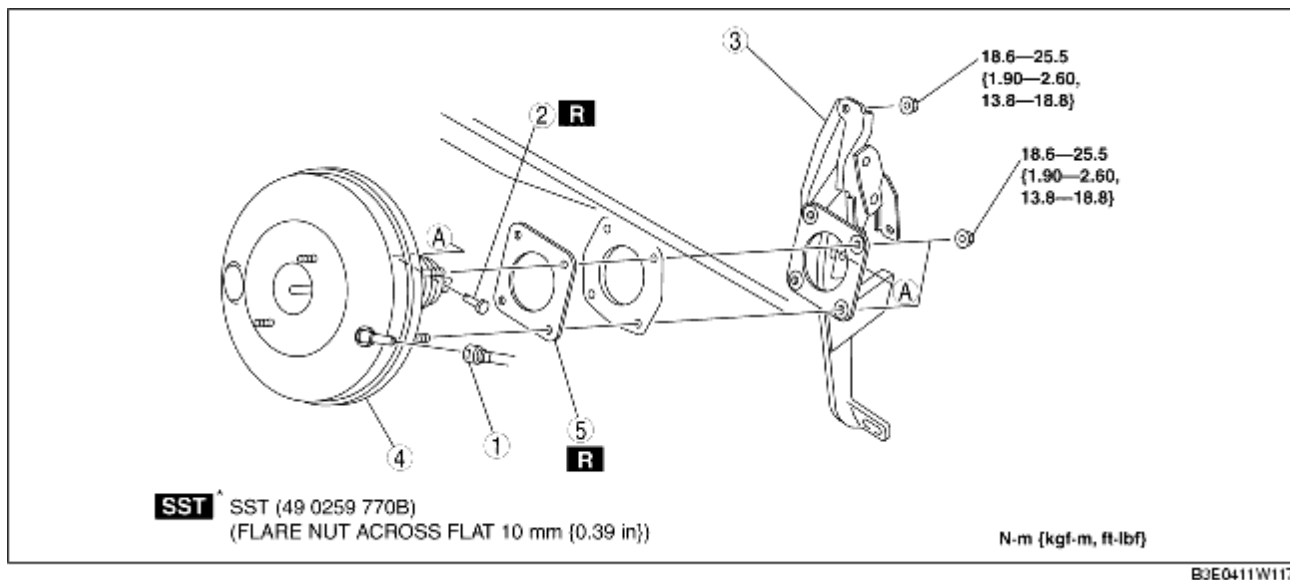

1	Vacuum hose (See VACUUM HOSE REMOVAL/INSTALLATION .)
2	Joint pin (See BRAKE PEDAL REMOVAL/INSTALLATION .)
3	Brake pedal component (See Brake Pedal Component Removal Note .)
4	Power brake unit
5	Gasket

Brake Pedal Component Removal Note

1. Remove the brake pedal installation nuts.
2. Move the power brake unit toward the vehicle rear.
3. Remove the brake pedal component.